

**Inkjet Printer**  
**UX Series**

**HITACHI**  
Inspire the Next

# UX Series



**Coding Solutions by Hitachi**



# Hitachi UX-Series

For over 40 years, Hitachi has developed and produced high-performance ink jet printers based on the well-proven Continuous InkJet (CIJ) principle for industrial marking.

Hitachi Industrial IJ printers are high-speed printers adopting a non-contact printing method, ideal for a wide range of applications. They are capable of applying best before dates, logos, barcodes, lot numbers and data matrix codes, which makes the new UX-Series the perfect solution for both complex and standard applications.

The UX-Series is a global model with highly evolved “Reliability”, “Efficiency”, “Ease of Use” and even “Eco-friendly” performance.

## **High reliability**

Hitachi Products are renowned for being extremely reliable in harsh environments. All functionally critical parts are manufactured in-house. The use of Hitachi's own components reinforces the high quality levels, reliability and excellent value for money.

## **Cost-effective**

The new economical ink recovery technique achieves industry-leading levels of make-up consumption and the very low maintenance costs minimise the total cost of ownership.





### Global sales & service network

Are you looking for a proven global company that can work with you at a local level? Hitachi offers a global sales and service network when marking, coding and traceability challenges demand a coordinated answer. For each of your locations, and across your entire organization we will champion your goals by providing international consistency, global perspective, broad expertise and coordinated service with dedicated contacts. Our global team applies its worldwide technical expertise to your unique challenges in a

consistent way. Tangible deliverables and proven solutions are results of our business analysis and project implementation. Mechanical integration supported by 3D CAD design, electrical schematics, customized circuits, application specifications and customized documents. In addition, cross-border project management and coordination between suppliers, OEM's and end-users are part of our deliveries. You gain more visibility and save time and money.

# Simplicity



## **Mess-free, Mistake-proof Fluid Refills**

Intelligent fluid cartridges reduce the possibility of hazardous fluid spills during refill. Shaped differently, the Ink and Make-up cartridges are easily identifiable as well as sized to fit in each respective receptacle.



## **RFID Recognition**

Error reduction is key to increased uptime and that's why the UX Series now features RFID\* Recognition for ink and make-up replacement. A quick scan of each bottle allows the system to identify the fluid in question and instruct the operator based on compatibility.

\*Some geographic areas are excluded.

Hitachi Industrial Equipment Systems Co. Ltd. declares that the IC tag reader is in compliance with the essential requirements and other relevant provisions of the FDD Part 15 subpart C, EN 301 489 1/3, EN 300 330-1/2







### Tool-less Filter Replacement

Ink filters can be replaced without the use of tools or a technician, resulting in virtually zero downtime for easy maintenance. No more mandatory, time-based failure due to machine operation.

(Original Hitachi patent: EP 226 1037 A1 / EP 230 5470 A1)

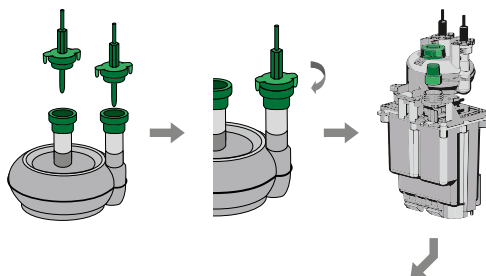

### IC Card with RFID function

With the new Hitachi IC Card any login information and print data can be managed fast, easy, and safely.

#### User Login

By scanning the IC Card, only the registered user can login quickly without entering a password. Each user operation can be limited to prevent human error.

#### Print data selection

By scanning the IC Card the print data can be quickly called up. Prevent calling up incorrect data which may happen with manual operation.





# Intuitive Machine Interface



## Intuitive User Interface

A 10.4-inch TFT LCD touch-panel screen provides a wide, easy-to-see viewing angle and intuitive operation. In addition, when changing print messages, a preview function allows the operator to verify on-screen what message will be changed to help avoid erroneous printing.



## On-Screen Guidance

The UX Series features an integrated, easy to access troubleshooting guide, helping operators easily find answers to common issues and reducing downtime due to simple problems.

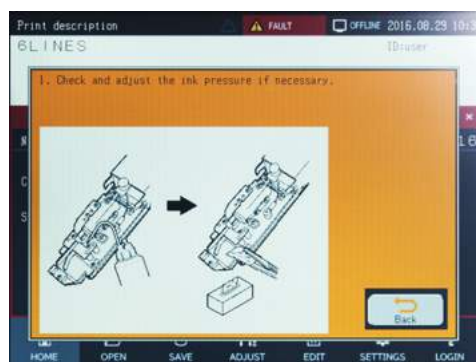





### Convenient Remote Management

Ethernet is a standard feature on UX machines.\* In addition, open network is supported, allowing easier system integration. Collective management via a host system enables two or more devices to be easily networked.

\* UX-B excluded

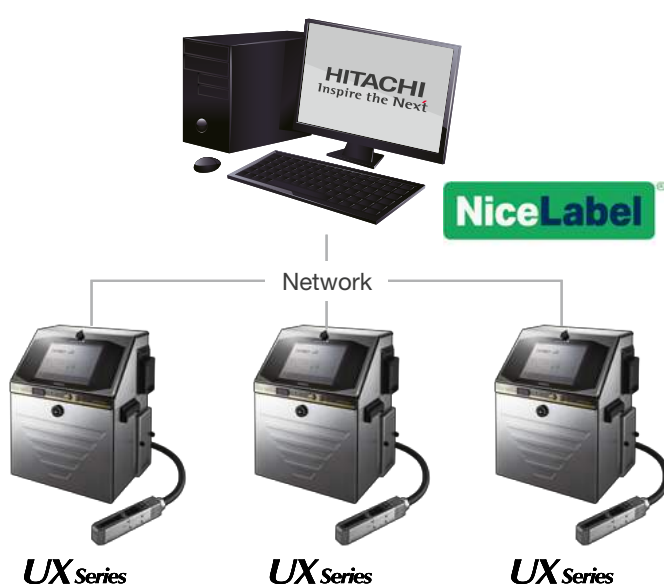

### Print Error Recognition

The Hitachi Vision System has been optimised to work with Ink Jet typical dot matrix characters. It verifies the content of each printed message instantaneously while allowing for typical CIJ character variations, assuring an optimal level of print quality.

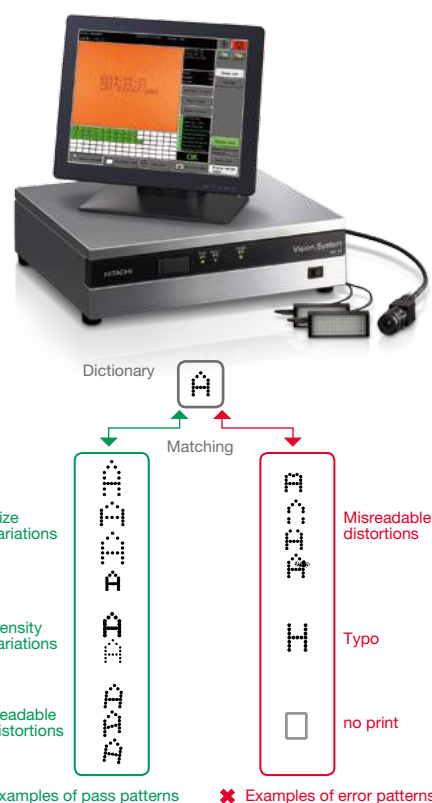



# Versatile, Durable Print Head



## Versatile Tapered Print Head

Proximity to product can be challenging using traditional print heads, but the UX's new Tapered print head technology allows for even closer printing, resulting in improved print quality.



## Durable Ni-Cr Plating

The UX-Series print head features a new Nickel-Chrome finish, giving it exceptional corrosion resistance and increasing the print head's lifespan in demanding environments like those requiring wash-down or exposure to caustic chemicals.



## Up to 6-Line Print

A single UX print head can print up to six lines by employing an innovative print control system. High-speed single line printing of excellent quality is also possible. Hitachi's original interlaced-print-control-system makes each print character appear extremely clear regardless of print height.







# Reliability



## Pump Unit (Valves and Camshaft)

At the heart of the UX Series inkjet printer is a diaphragm based circulation system. Unique to Hitachi, the UX's diaphragm system dramatically improves reliability, leading to a reduction in total cost of ownership.

A dedicated viscometer gives a true measure of the ink's viscosity further increasing reliability and uptime.



## Reduced Make-up Consumption and Running Cost

Motor Speed Control Function suppresses make-up evaporation and offers industry-leading level of make-up consumption.

The premium model UX-E achieves a consumption of only 2.5 ml/h thanks to Hitachi's latest patented Fluid Consumption Reduction System.

# 2.5 ml/h\*

\*Hitachi Ink 1067k at 20°C



## Designed for harsh environments

The stainless steel cabinet offers IP65 and allows a wash-down with pressured water and industrial detergent, to meet any environment and hygiene requests. The UX Series with IP65 protection is the ideal choice for applications in the meat and dairy industries.

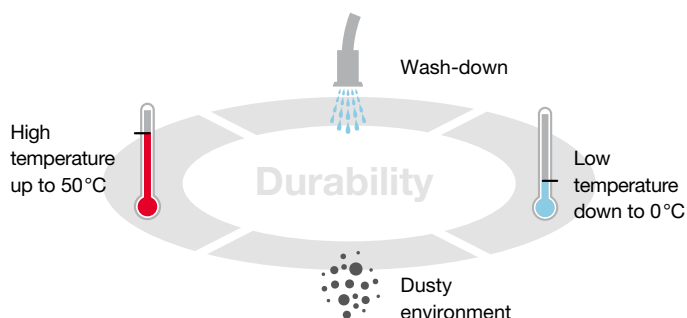



# Twin Nozzle Model



## Flexible 8 Line Print

The UX twin print head now offers the ability to produce 8 lines of text by combining two individual nozzles into one, compact design. In addition, by utilizing Hitachi's first on the market "interlaced" print control technique, multiple line messages are printed clearly and legibly, further reducing coding errors due to misprint.



## High-speed printing

Two nozzles at one print head realizes double-speed printing, which can track even on a high-speed production line, resulting in high-quality printing regardless of the number of print lines.



## Versatile 64-Dot

Hitachi's innovative design now produces 64 vertical dots of print, resulting in large, bold characters. This makes the UX twin nozzle printer ideally suited to mark company logos, UL marks, or any other pattern previously unachievable with traditional print heads.



## Character Stitch Capability

A unique option in the new twin-nozzle printer is the ability to stitch both nozzles together. This results in characters that are bigger and bolder than ever, compared to those printed by individual nozzles. This is particularly useful when character recognition is needed at a distance from the product.

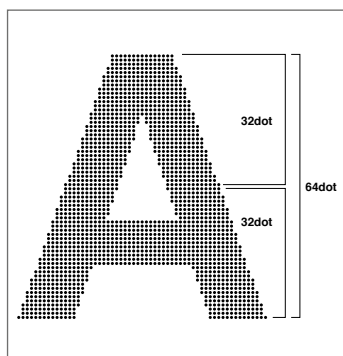

Image is for illustration purposes





# UX-P For Pigmented Inks



## UX-P for pigmented inks

The UX Printer is designed for high contrast marking on dark surfaces with pigmented inks at highest quality. Typical application areas include automotive parts, cables, plastic piping and electronic components.



## Pigmented ink stirring system

The electric stirrer system prevents the agglomeration and the setting of pigments.

In addition, the Pigment model is equipped with an "Ink circulation control" function, which allows the ink to circulate even in a standby mode to avoid the ink fixing and ensures a smooth operation during production.

Smooth supply for ink and make-up fluid  
Ink and make-up fluid can be supplied at any time with no interruption

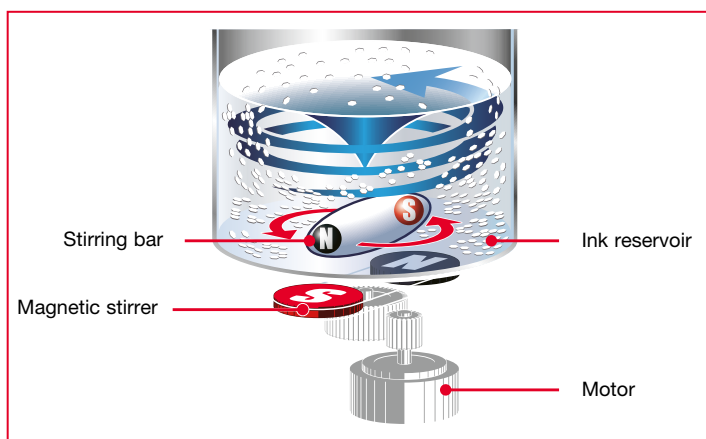

Electric stirrer





# UX-B Model

65 μm  
(Standard)

## Standard Print Samples

5 x 5	1 LINE	0123456789ABCDEF6H	2 LINE	012345678	3 LINE	012345678 ABCDEFGHI JKLMNOPQR	6 LINE	0123456789 ABCDEFGHI JKLMNOPQR STUVWXYZ 0123456789 ABCDEFGHI JKLMNOPQR STUVWXYZ
	2 LINE	012345678		ABCDEFGHI				
5 x 7	1 LINE	0123456789ABC	2 LINE	012345678	3 LINE	012345678 ABCDEFGHI JKLMNOPQR	4 LINE	012345678 ABCDEFGHI JKLMNOPQR STUVWXYZ
	2 LINE	0123456		ABCDEFGHI				
7 x 10	1 LINE	0123456789	2 LINE	01234567	3 LINE	0123456789013456 ABCDEFGHIJKLNOPO TUVWXYZABCDEFGHIJ		
	2 LINE	012345		ABCDEFGH				
10 x 12	1 LINE	0123456789ABC	2 LINE	01234567890		01234567890 ABCDEFGHIJK		
	2 LINE	0123456789						
12 x 16	1 LINE	0123456789ABC	2 LINE	012		012		
	2 LINE	0123456		01		ABC		
18 x 24	1 LINE	0123456789						
	2 LINE	0123456ABC						
24 x 32	1 LINE	012345ABCD						
30 x 40	1 LINE	012345ABCDEF						
36 x 48	1 LINE	012345ABCD						

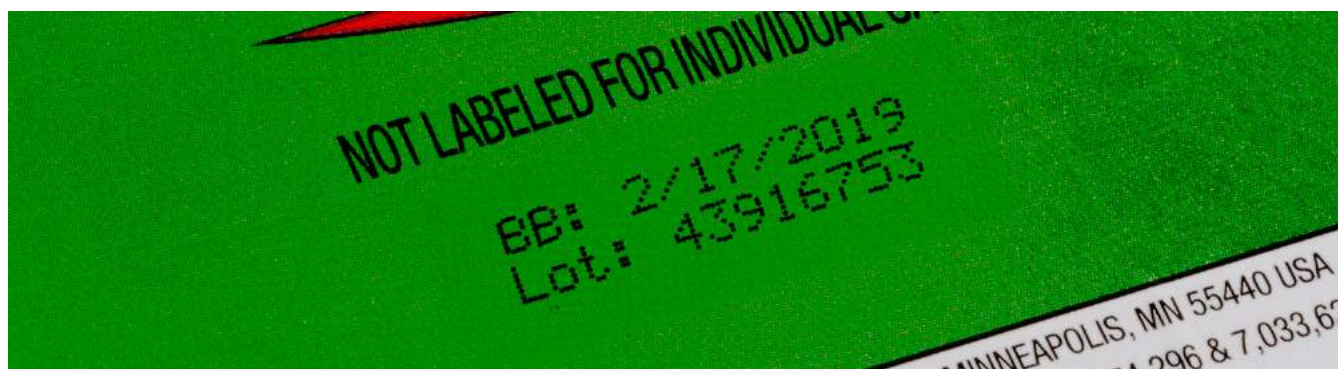



## Standard Specifications

Item		UX-B160W
Nozzle Size		65µm
Maximum number of print lines		Up to 3 lines
Maximum number of print characters		Up to 240 characters
Font (Horizontal x Vertical)	4 x 5	-
	5 x 5	✓
	5 x 7(8), 9 x 7(8)	✓
	7 x 10	✓
	11 x 11	✓ (Chinese only)
	10 x 12	✓
	12 x 16	✓
	18 x 24	✓
	24 x 32	-
	30 x 40	-
	36 x 48	-
Character height		2 - 10 mm
Display & input device		WYSIWYG design Display: TFT LCD (10.4" color), backlight provided Input device: Touch panel, input sound provided
Screen language (2 languages selectable)		English, Chinese, Korean, Thai, Vietnamese, German, French, Dutch, Italian, Spanish, Portuguese, Swedish, Danish, Greek, Russian, Czech, Polish, Arabic, Serbian, Turkish, Hungarian, Bulgarian, Catalan, Romanian, Finnish, Norwegian, Slovenian
Maximum print rate (Character per second) (Font 5x5, space 1, 1 line)		Up to 1,281
Standard characters		Alphanumeric (A-Z, a-z, 0-9), symbols (27) and space: Total 90
User patterns		50 patterns each for dot matrix
Print functions		Calendar, Count, Font mixture, Password
Barcode printing		-
2D printing		-
Message storage capacity		150 Messages
Input signal		Print target detection, Rotary encoder pulse, (NPN/PNP Selectable)
Output signal		Print ready, Fault, Warning (NPN Only)
Data interface		Option (RS-232C at baud rates selectable up to 115,200bps)
Ethernet (Modbus communication)		-
External memory		USB for user data storage
Printhead cable length / angle		4m (in-line/90 degrees)
Operating temperature range		0-45°C (1069K Ink)*
Operating humidity range		30-90% RH (no condensation)
Power supply (Automatic voltage selection)		AC100-120/220-240V±10% 50/60Hz 120 VA
Approval		CE, UL, cUL, C-Tick, FCC, ICES
Dimensions (Width x Depth x Height)		400 x 320 x 527 mm
International protection		IP55

\* Ink types and temperature are limited.



Note: Main unit dimensions do not include any projections.



# UX-D Model

65 μm  
(Standard)

## Standard Print Samples

5 x 5	1 LINE	0123456789ABCDEFGHI	2 LINE	012345678 ABCDEFGHI	3 LINE	012345678 ABCDEFGHI JKLMNOPQR	6 LINE	0123456789ABCDEFGHI JKLMNOPQR
		012345678						
5 x 7	1 LINE	0123456789ABC	2 LINE	012345678 ABCDEFGHI	3 LINE	012345678 ABCDEFGHI JKLMNOPQR	4 LINE	0123456789ABCDEFGHI JKLMNOPQR
		0123456						
7 x 10	1 LINE	0123456789	2 LINE	01234567 ABCDEFGH	3 LINE	0123456789013456 ABCDEFGHIJKLNO PQRSTUVWXYZABCDEFGHIJ		
		012345						
10 x 12	1 LINE	0123456789ABC	2 LINE	01234567890 ABCDEFGHIJK				
		0123456789						
12 x 16	1 LINE	0123456789ABC	2 LINE	012345678901 ABCDEFGHIJKL				
		012345678901						
18 x 24	1 LINE	0123456789						
		0123456789						
24 x 32	1 LINE	0123456789						
		0123456789						
30 x 40	1 LINE	0123456789						
		0123456789						
36 x 48	1 LINE	0123456789						
		0123456789						





## Standard Specifications

Item		UX-D160W
Nozzle Size		65µm
Maximum number of print lines		Up to 6 lines
Maximum number of print characters		Up to 240 characters (Option: Up to 1,000 characters)
Font (Horizontal x Vertical)	4 x 5	✓
	5 x 5	✓
	5 x 7(8) 9 x 7(8)	✓
	7 x 10	✓
	11 x 11	✓ (Chinese only)
	10 x 12	✓
	12 x 16	✓
	18 x 24	✓
	24 x 32	✓
	30 x 40	✓
	36 x 48	✓
Character height		2 - 10 mm
Display & input device		WYSIWYG design display: TFT LCD (10.4" color), backlight provided input device: Touch panel, input sound provided
Screen language (2 languages selectable)		English, Chinese, Korean, Thai, Vietnamese, German, French, Dutch, Italian, Spanish, Portuguese, Swedish, Danish, Greek, Russian, Czech, Polish, Arabic, Serbian, Turkish, Hungarian, Bulgarian, Catalan, Romanian, Finnish, Norwegian, Slovenian
Maximum print rate (Character per second) (Font 5x5, space 1, 1 line)		Up to 1,148 (Option: Up to 2,563)
Standard characters		Alphanumeric (A-Z, a-z, 0-9), symbols (27) and space: Total 90
User patterns		200 patterns each for dot matrix (50 patterns for 30x40 and 36x48 fonts)
Print functions		Calendar, Count, Font mixture, Password
Barcode printing		code39, ITF, NW-7, EAN-13, EAN-8, UPC-A, UPC-E, code128/EAN-128, GS-1 DataBar
2D printing		Data Matrix (Alphabet: 49 characters/Numbers: 98 characters), QR Code, Micro QR code
Message storage capacity		300 Messages [Option: Up to 2,000 Messages (depends on data content)]
Input signal		Print target detection, Printing stop, Rotary encoder pulse, Reciprocal printing, Remote control (Run, Stop, High-voltage ON/OFF, Reset), (NPN/PNP Selectable)
Output signal		Print in progress or Print complete, Online (NPN/PNP Selectable), Print ready, Fault, Warning (NPN Only)
Data interface		RS-232C at baud rates selectable up to 115,200bps
Ethernet (Modbus communication)		IEEE802.3, 100BASE-T
External memory		USB for user data storage
Printhead cable length / angle		4m (in-line/90 degrees)
Operating temperature range		0-45°C (1069K Ink)*
Operating humidity range		30-90% RH (no condensation)
Power supply (Automatic voltage selection)		AC100-120/220-240V±10% 50/60Hz 120 VA
Approval		CE, UL, cUL, C-Tick, FCC, ICES
Dimensions (Width x Depth x Height)		400 x 320 x 527 mm
International protection		IP65
Approximate weight		27kg

\* Ink types and temperature are limited.

\*\* Please consult your sales representative for further upgrade options.



Note: Main unit dimensions do not include any projections.



# UX-D Model

55 μm  
(High-Speed)

## Standard Print Samples

5 x 5	1 LINE	0123456789ABCDEFGH	2 LINE	012345678 ABCDEFGHI	3 LINE	012345678 ABCDEFGHI JKLMNOPQR	6 LINE	0123456789 ABCDEFGHI JKLMNOPQR STUVWXYZ 0123456789 ABCDEFGHI JKLMNOPQR STUVWXYZ
		012345678						
5 x 7	1 LINE	0123456789ABC	2 LINE	012345678 ABCDEFGHI	3 LINE	012345678 ABCDEFGHI JKLMNOPQR	4 LINE	0123456789 ABCDEFGHI JKLMNOPQR STUVWXYZ
		0123456						
7 x 10	1 LINE	0123456789	2 LINE	01234567 ABCDEFGH	3 LINE	012345678901234567 ABCDEFGHIJKLMN OPQRSTUVWXYZ		
		012345						
12 x 16	1 LINE	0123456789ABC					2 LINE	01234 ABCDE
		012345	01					
18 x 24	1 LINE	0123456789						
		0123456ABC						





## Standard Specifications

Item		UX-D150W
Nozzle Size		55µm
Maximum number of print lines		Up to 4 lines
Maximum number of print characters		Up to 1,000 characters
Font (Horizontal x Vertical)	4 x 5	✓
	5 x 5	✓
	5 x 7(8) 9 x 7(8)	✓
	7 x 10	✓
	11 x 11	-
	10 x 12	-
	12 x 16	✓
	18 x 24	✓**
	24 x 32	-
	30 x 40	-
	36 x 48	-
Character height		2 - 8 mm
Display & input device		WYSIWYG design display: TFT LCD (10.4" color), backlight provided input device: Touch panel, input sound provided
Screen language (2 languages selectable)		English, Chinese, Korean, Thai, Vietnamese, German, French, Dutch, Italian, Spanish, Portuguese, Swedish, Danish, Greek, Russian, Czech, Polish, Arabic, Serbian, Turkish, Hungarian, Bulgarian, Catalan, Romanian, Finnish, Norwegian, Slovenian
Maximum print rate (Character per second) (Font 5x5, space 1, 1 line)		Up to 3,173
Standard characters		Alphanumeric (A-Z, a-z, 0-9), symbols (27) and space: Total 90
User patterns		200 patterns each for dot matrix
Print functions		Calendar, Count, Font mixture, Password
Barcode printing		code39, ITF, NW-7, EAN-13, EAN-8, UPC-A, UPC-E, code128/EAN-128, GS-1 DataBar
2D printing		Data Matrix (Alphabet: 49 characters/Numbers: 98 characters), QR Code, Micro QR code
Message storage capacity		300 Messages [Option: Up to 2,000 Messages (depends on data content)]
Input signal		Print target detection, Printing stop, Rotary encoder pulse, Reciprocativ printing, Remote control (Run, Stop, High-voltage ON/OFF, Reset), (NPN/PNP Selectable)
Output signal		Print in progress or Print complete, Online (NPN/PNP Selectable), Print ready, Fault, Warning (NPN Only)
Data interface		RS-232C at baud rates selectable up to 115,200bps
Ethernet (Modbus communication)		IEEE802.3, 100BASE-T
External memory		USB for user data storage
Printhead cable length / angle		4m (in-line/90 degrees)
Operating temperature range		0-40°C (1069K Ink)*
Operating humidity range		30-90% RH (no condensation)
Power supply (Automatic voltage selection)		AC100-120/220-240V±10% 50/60Hz 120 VA
Approval		CE, UL, cUL, C-Tick, FCC, ICES
Dimensions (Width x Depth x Height)		400 x 320 x 527 mm
International protection		IP65
Approximate weight		27kg

\* Ink types and temperature are limited.

\*\* Please consult your sales representative for further upgrade options.



Note: Main unit dimensions do not include any projections.



(Small Characters)



## Standard Specifications

Item		UX-D140W
Nozzle Size		40µm
Maximum number of print lines		Up to 4 lines
Maximum number of print characters		Up to 1,000 characters
Font (Horizontal x Vertical)	4 x 5	✓
	5 x 5	✓
	5 x 7(8) 9 x 7(8)	✓
	7 x 10	✓
	11 x 11	✓ (Chinese only)
	10 x 12	-
	12 x 16	✓
	18 x 24	✓
	24 x 32	✓
	30 x 40	-
	36 x 48	-
Character height		1 - 5mm
Display & input device		WYSIWYG design display: TFT LCD (10.4" color), backlight provided input device: Touch panel, input sound provided
Screen language (2 languages selectable)		English, Chinese, Korean, Thai, Vietnamese, German, French, Dutch, Italian, Spanish, Portuguese, Swedish, Danish, Greek, Russian, Czech, Polish, Arabic, Serbian, Turkish, Hungarian, Bulgarian, Catalan, Romanian, Finnish, Norwegian, Slovenian
Maximum print rate (Character per second) (Font 5x5, space 1, 1 line)		Up to 3,030
Standard characters		Alphanumeric (A-Z, a-z, 0-9), symbols (27) and space: Total 90
User patterns		200 patterns each for dot matrix
Print functions		Calendar, Count, Font mixture, Password
Barcode printing		code39, ITF, NW-7, EAN-13, EAN-8, UPC-A, UPC-E, code128/EAN-128, GS-1 DataBar
2D printing		Data Matrix (Alphabet: 49 characters/Numbers: 98 characters), QR Code, Micro QR code
Message storage capacity		300 Messages [Option: Up to 2,000 Messages (depends on data content)]
Input signal		Print target detection, Printing stop, Rotary encoder pulse, Reciprocatve printing, Remote control (Run, Stop, High-voltage ON/OFF, Reset), (NPN/PNP Selectable)
Output signal		Print in progress or Print complete, Online (NPN/PNP Selectable), Print ready, Fault, Warning (NPN Only)
Data interface		RS-232C at baud rates selectable up to 115,200bps
Ethernet (Modbus communication)		IEEE802.3, 100BASE-T
External memory		USB for user data storage
Printhead cable length / angle		4m (in-line/90 degrees)
Operating temperature range		0-35°C (1069K Ink)*
Operating humidity range		30-90% RH (no condensation)
Power supply (Automatic voltage selection)		AC100-120/220-240V±10% 50/60Hz 120 VA
Approval		CE, UL, cUL, C-Tick, FCC, ICES
Dimensions (Width x Depth x Height)		400 x 320 x 527 mm
International protection		IP65
Approximate weight		27kg

\* Ink types and temperature are limited.

\*\* Please consult your sales representative for further upgrade options.



Note: Main unit dimensions do not include any projections.



# UX-D Model

100 μm

(Large Characters)

## Standard Print Samples

4 x 5	1 LINE 01234567	2 LINE 01234567 ABCDEFGH	3 LINE 01234567 ABCDEFGH IJKLMNOP	4 LINE 01234567 ABCDEFGH IJKLMNOP 89012345
5 x 5	1 LINE 01234567	2 LINE 0123456 ABCDEFG	3 LINE 12345678 ABCDEFGH 89012345	4 LINE 12345678 ABCDEFGH 89012345 IJKLMNOP
5 x 7	1 LINE 12345678	2 LINE 12345678 ABCDEFGH	3 LINE 12345678 ABCDEFGH 90123456	4 LINE 12345678 ABCDEFGH 90123456 IJKLMNOP
9 x 7	1 LINE 12345678	2 LINE 12345678 ABCDEFGH	3 LINE 123456789 ABCDEFGHI 012345678	4 LINE 123456789 ABCDEFGHI 012345678 JKLMNOPQR
7 x 10	1 LINE 1234567	2 LINE 123456 ABCDEF	3 LINE 123456789 ABCDEFGHI 012345678	
12 x 16	1 LINE 123456789			2 LINE 12345 ABCDE
18 x 24	1 LINE 123456789			
24 x 32	1 LINE 123456789			



## Standard Specifications

Item		UX-D110W
Nozzle Size		100µm
Maximum number of print lines		Up to 4 lines
Maximum number of print characters		Up to 1,000 characters
Font (Horizontal x Vertical)	4 x 5	✓
	5 x 5	✓
	5 x 7(8) 9 x 7(8)	✓
	7 x 10	✓
	11 x 11	-
	10 x 12	-
	12 x 16	✓
	18 x 24	✓
	24 x 32	✓
	30 x 40	-
	36 x 48	-
Character height		3 - 15 mm
Display & input device		WYSIWYG design display: TFT LCD (10.4" color), backlight provided input device: Touch panel, input sound provided
Screen language (2 languages selectable)		English, Chinese, Korean, Thai, Vietnamese, German, French, Dutch, Italian, Spanish, Portuguese, Swedish, Danish, Greek, Russian, Czech, Polish, Arabic, Serbian, Turkish, Hungarian, Bulgarian, Catalan, Romanian, Finnish, Norwegian, Slovenian
Maximum print rate (Character per second) (Font 5x5, space 1, 1 line)		Up to 468
Standard characters		Alphanumeric (A-Z, a-z, 0-9), symbols (27) and space: Total 90
User patterns		200 patterns each for dot matrix
Print functions		Calendar, Count, Font mixture, Password
Barcode printing		code39, ITF, NW-7, EAN-13, EAN-8, UPC-A, UPC-E, code128/EAN-128, GS-1 DataBar
2D printing		Data Matrix (Alphabet: 49 characters/Numbers: 98 characters), QR Code, Micro QR code
Message storage capacity		300 Messages [Option: Up to 2,000 Messages (depends on data content)]
Input signal		Print target detection, Printing stop, Rotary encoder pulse, Reciprocal printing, Remote control (Run, Stop, High-voltage ON/OFF, Reset), (NPN/PNP Selectable)
Output signal		Print in progress or Print complete, Online (NPN/PNP Selectable), Print ready, Fault, Warning (NPN Only)
Data interface		RS-232C at baud rates selectable up to 115,200bps
Ethernet (Modbus communication)		IEEE802.3, 100BASE-T
External memory		USB for user data storage
Printhead cable length / angle		4m (in-line/90 degrees)
Operating temperature range		0-35°C (1069K Ink)*
Operating humidity range		30-90% RH (no condensation)
Power supply (Automatic voltage selection)		AC100-120/220-240V±10% 50/60Hz 120 VA
Approval		CE, UL, cUL, C-Tick, FCC, ICES
Dimensions (Width x Depth x Height)		400 x 320 x 527 mm
International protection		IP65
Approximate weight		27kg

\* Ink types and temperature are limited.

\*\* Please consult your sales representative for further upgrade options.



Note: Main unit dimensions do not include any projections.





# UX-E Model

65 μm  
(Standard)

Standard Print Samples									
5 x 5	1 LINE	0123456789ABCDEFGH	2 LINE	012345678 ABCDEFGHI	3 LINE	012345678 ABCDEFGHI JKLMNOPQR	6 LINE	0123456789 ABCDEFGHI JKLMNOPQR STUVWXY ZABCDEFGHI JKLMNOPQR STUVWXY ZABCDEFGHI JKLMNOPQR	
		012345678							
5 x 7	1 LINE	0123456789ABC	2 LINE	012345678 ABCDEFGHI	3 LINE	012345678 ABCDEFGHI JKLMNOPQR	4 LINE	0123456789 ABCDEFGHI JKLMNOPQR STUVWXYZA	
		0123456							
7 x 10	1 LINE	0123456789	2 LINE	01234567 ABCDEFGH	3 LINE	0123456789013456 ABCDEFGHIJKLNO PQRSTUVWXYZA BCDEFGHIJ			
		012345							
10 x 12	1 LINE	0123456789ABC	2 LINE	01234567890 ABCDEFGHIJK					
		0123456789							
12 x 16	1 LINE	0123456789ABC	2 LINE	01234567890 ABCDEFGHIJK					
		0123456		01					
18 x 24	1 LINE	0123456789							
		0123456ABC							
24 x 32	1 LINE	012345ABCD							
30 x 40	1 LINE	012345ABCDEF							
36 x 48	1 LINE	012345ABCD							



## Standard Specifications

Item		UX-E160W
Nozzle Size		65µm
Maximum number of print lines		Up to 6 lines
Maximum number of print characters		Up to 1,000 characters
Font (Horizontal x Vertical)	4 x 5	✓
	5 x 5	✓
	5 x 7(8), 9 x 7(8)	✓
	7 x 10	✓
	11 x 11	✓ (Chinese only)
	10 x 12	✓
	12 x 16	✓
	18 x 24	✓
	24 x 32	✓
	30 x 40	✓
	36 x 48	✓
Character height		2 - 10 mm
Display & input device		WYSIWYG design Display: TFT LCD (10.4" color), backlight provided Input device: Touch panel, input sound provided
Screen language (2 languages selectable)		English, Chinese, Korean, Thai, Vietnamese, German, French, Dutch, Italian, Spanish, Portuguese, Swedish, Danish, Greek, Russian, Czech, Polish, Arabic, Serbian, Turkish, Hungarian, Bulgarian, Catalan, Romanian, Finnish, Norwegian, Slovenian
Maximum print rate (Character per second) (Font 5x5, space 1, 1 line)		Up to 2,563
Standard characters		Alphanumeric (A-Z, a-z, 0-9), symbols (27) and space: Total 90
User patterns		200 patterns each for dot matrix (50 patterns for 30x40 and 36x48 fonts)
Print functions		Calendar, Count, Font mixture, Password
Barcode printing		code39, ITF, NW-7, EAN-13, EAN-8, UPC-A, UPC-E, code128/EAN-128, GS-1 DataBar
2D printing		Data Matrix (Alphabet: 49 characters/Numerals: 98 characters), QR, Micro QR code
Message storage capacity		2,000 Messages (Depends on data content)
Input signal		Print target detection, Printing stop, Rotary encoder pulse, Reciprocal printing, Remote control (Run, Stop, High-voltage ON/OFF, Reset), (NPN/PNP Selectable)
Output signal		Print in progress or Print complete, Online (NPN/PNP Selectable), Print ready, Fault, Warning (NPN Only)
Data interface		RS-232C at baud rates selectable up to 115,200bps
Ethernet (Modbus communication)		IEEE802.3, 100BASE-T
External memory		USB for user data storage
Printhead cable length / angle		4m (in-line/90 degrees)
Operating temperature range		0-45°C (1067K Ink)*
Operating humidity range		30-90% RH (no condensation)
Power supply (Automatic voltage selection)		AC100-120/220-240V±10% 50/60Hz 120 VA
Approval		CE, C-Tick
Dimensions (Width x Depth x Height)		400 x 320 x 527 mm
International protection		IP65
Approximate weight		27kg

\* Ink types and temperature are limited.



Note: Main unit dimensions do not include any projections.





## Standard Specifications

Item		UX-P160W
Nozzle Size		65µm
Maximum number of print lines		Up to 6 lines
Maximum number of print characters		Up to 1,000 characters
Font (Horizontal x Vertical)	4 x 5	✓
	5 x 5	✓
	5 x 7(8), 9 x 7(8)	✓
	7 x 10	✓
	11 x 11	✓ (Chinese only)
	10 x 12	✓
	12 x 16	✓
	18 x 24	✓
	24 x 32	✓
	30 x 40	✓
	36 x 48	✓
Character height		2 - 10 mm
Display & input device		WYSIWYG design Display: TFT LCD (10.4" color), backlight provided Input device: Touch panel, input sound provided
Screen language (2 languages selectable)		English, Chinese, Korean, Thai, Vietnamese, German, French, Dutch, Italian, Spanish, Portuguese, Swedish, Danish, Greek, Russian, Czech, Polish, Arabic, Serbian, Turkish, Hungarian, Bulgarian, Catalan, Romanian, Finnish, Norwegian, Slovenian
Maximum print rate (Character per second) (Font 5x5, space 1, 1 line)		Up to 2,083 (JP-W89 Ink)
Standard characters		Alphanumeric (A-Z, a-z, 0-9), symbols (27) and space: Total 90
User patterns		200 patterns each for dot matrix
Print functions		Calendar, Count, Font mixture
Barcode printing		code39, ITF, NW-7, EAN-13, EAN-8, UPC-A, UPC-E, code128/EAN-128, GS-1 DataBar
2D printing		Data Matrix (Alphabet: 49 characters/Numerals: 98 characters), QR, Micro QR code
Message storage capacity		Up to 2,000 Messages (Depends on data content)
Input signal		Print target detection, Printing stop, Rotary encoder pulse, Reciprocal printing, Remote control (Run, Stop, High-voltage ON/OFF, Reset), (NPN/PNP Selectable)
Output signal		Print in progress or Print complete, Online (NPN/PNP Selectable), Print ready, Fault, Warning (NPN Only)
Data interface		RS-232C at baud rates selectable up to 115,200bps
Ethernet (Modbus communication)		IEEE802.3, 100BASE-T
External memory		USB for user data storage
Printhead cable length / angle		4m (in-line/90 degrees)
Operating temperature range		0-40°C (JP-W89 Ink)
Operating humidity range		30-90% RH (no condensation)
Power supply (Automatic voltage selection)		AC100-120/220-240V±10% 50/60Hz 120 VA
Approval		CE, UL, cUL, RCM, FCC, ICES
Dimensions (Width x Depth x Height)		400 x 320 x 527 mm
International protection		IP65
Approximate weight		27kg

Hitachi Industrial Equipment Systems Co., Ltd. (Hitachi) shall not be liable for any manufacturing loss, or any product damage due to trouble or malfunction of the ink jet printer. Hitachi continually improves products. The right, therefore, is reserved to alter the designs and/or specifications without giving prior notice. Information in this brochure is subject to change without notice.







Note: Main unit dimensions do not include any projections.



# UX Twin Model

65 μm  
(Standard)

## Standard Print Samples

High-speed printing	2 LINE	Nozzle 2	01234567		2 LINE	Nozzle 2	01234567		
		Nozzle 1	ABCDEFGH			Nozzle 1	ABCDEFGH		
			160m/min Font: 5x7				200m/min Font: 5x7		
2, 3-line printing	2 LINE	Nozzle 2	01234567890		3 LINE	Nozzle 2	01234567890		
		Nozzle 1	ABCDEFGH IJK			Nozzle 1	TWINNOZZLE8		
			Font: 7x10				Font: 7x10		
Multi-line printing (4line, 8line)	4 LINE	Nozzle 2 (2 line English)	05/08/18 ABCD 05/02/19 1234		8 LINE	Nozzle 2 (4 line)	SELL BY AUG 8 MANUFACTURED BY HIES 11:37:17 BEST BY 05 FEB<FEB>2020 LOV 8929 0417 6557 HITACHI INDUSTRIAL EQUIPMENT : MADE IN JAPAN TEL: +81-4345-6077 IOS 9001		
		Nozzle 1 (2 line Arabic)	+0/+A/1A ABCD +0/+C/19 1C4E			Nozzle 1 (4 line)			
			Font: 5x8				Font: 5x7		
Dot mixture		Nozzle 2	ABCD BEST BY HIES UX 017H04 S28N02						
		Nozzle 1	05FEB<FEB>2019						
		Nozzle 2	UX TWIN TOKYO EXPO PACKAGING TECHNICAL AREA CODING 860						
		Nozzle 1	HITACHI INDUSTRIAL EQUIPMENT SYSTEMS						
			Font: 5x8 12x16						
Logos*		Nozzle 2		Nozzle 2		Nozzle 2		Nozzle 2	
		Nozzle 1		Nozzle 1		Nozzle 1		Nozzle 1	
			40 dots		48 dots		64 dots		64 dots
Bold characters		Nozzle 2	5x7 BOLD 2 LINE S 5x7 BOLD 2 LINE B						
		Nozzle 1	5x7 BOLD 2 LINE S 5x7 BOLD 2 LINE B						
			Font: 5x8 12x16						
Chimney characters		Nozzle 1	N X N O I H E Z W > A B H Z F			Nozzle 2	77		

\* When printing logos, please make sure the image is acceptable to the association or the organization.

\*\* This printing will be made with use of graphics data (dot-pattern) but not with 2D code function. This graphics data (dot-pattern) should be prepared by the users. Read rate will vary depending on the print condition.



## Standard Specifications

Item		UX-D860W
Nozzle Size		65µm
Maximum number of print lines		Up to 8 lines
Maximum number of print characters		Up to 1,000 characters
Font (Horizontal x Vertical)	4 x 5	✓
	5 x 5	✓
	5 x 7(8) 9 x 7(8)	✓
	7 x 10	✓
	11 x 11	✓ (Chinese only)
	10 x 12	✓
	12 x 16	✓
	18 x 24	✓
	24 x 32	✓
	30 x 40	✓*
	36 x 48	✓*
	48 x 64	✓*
Character height		2 - 21 mm
Display & input device		WYSIWYG design Display: TFT LCD (10.4" color), backlight provided Input device: Touch panel, input sound provided
Screen language (2 languages selectable)		English, Chinese, Korean, Thai, Vietnamese, German, French, Dutch, Italian, Spanish, Portuguese, Swedish, Danish, Greek, Russian, Czech, Polish, Arabic, Serbian, Turkish, Hungarian, Bulgarian, Catalan, Romanian, Finnish, Norwegian, Slovenian
Maximum print rate (Character per second) (Font 5x5, space 1, 1 line)		Up to 2,296 (Option: Up to 2,563) per nozzle
Standard characters		Alphanumeric (A-Z, a-z, 0-9), symbols (27) and space: Total 90
User patterns		200 patterns each for dot matrix (50 patterns for 30x40, 36x48, 48x64 fonts)
Print functions		Calendar, Count, Font mixture, Shift Code
Barcode printing		code39, ITF, NW-7, EAN-13, EAN-8, UPC-A, UPC-E, code128/EAN-128, GS-1 DataBar
2D code printing		Data Matrix (Alphabet: 49 characters/Numerals: 98 characters), QR Code, Micro QR code
Message storage capacity		Up to 2,000 messages (Depends on data content)
Input signal		Print target detection, Printing stop, Rotary encoder pulse, Reciprocative printing, Remote control (Run, Stop, High-voltage ON / OFF, Reset), (NPN / PNP Selectable)
Output signal		Print in progress or Print complete, Online (NPN / PNP Selectable), Print ready, Fault, Warning (NPN Only)
Data interface		RS-232C at baud rates selectable up to 115,200bps
Ethernet (Modbus communication)		IEEE802.3, 100BASE-T
External memory		USB for user data storage
Printhead cable length / angle		4m (in-line/90 degrees)
Operating temperature range		0-40° (1072K Ink)**
Operating humidity range		30-90% RH (no condensation)
Power supply (Automatic voltage selection)		AC100-120/220-240V±10% 50/60Hz 150VA
Approval		CE, UL, cUL, RCM, FCC, ICES
Dimensions (Width x Depth x Height)		400 x 395 x 527 mm
International protection		IP55
Approximate weight		34kg

\* The character is printed with the composite character made by the user patterns for both nozzles 1 and 2.

\*\* Ink types and temperature are limited.

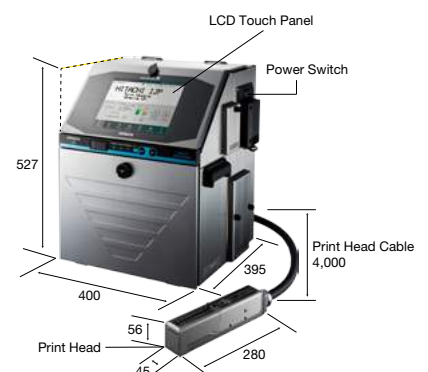

Note: Main unit dimensions do not include any projections.





# HITACHI

## Inspire the Next

Please follow us:



Hitachi Europe GmbH, Niederkasseler Lohweg 191, D-40547 Düsseldorf  
Phone: +49(0)211-5283-0  
[www.hitachi-industrial.eu](http://www.hitachi-industrial.eu), [info@hitachi-ds.com](mailto:info@hitachi-ds.com)  
Hitachi Industrial Equipment Systems Co., Ltd., Japan

All company and product names in this brochure are the property of the respective companies.